

ERGOLIFT-PRO

ADJUSTABLE BED

**Rest, recline, rise. Pro-level
comfort with one click.**

ecosa

Congratulations on your new ErgoLift-Pro Adjustable Bed.

With ErgoLift-Pro, you're in control. Fine-tune your comfort with massage and elevation at the click of a button. Your Adjustable Bed can be used as a standalone base, on an existing bed base (on top of slats) or within a bed frame/base (with slats removed). However you're using it, ErgoLift-Pro offers customised support for your sleep and health.



Please Note: This booklet is for the ErgoLift-Pro Adjustable Bed only. If you've purchased this as part of another bed base from Ecosa, you'll need to set the other base up separately, using the assembly instructions it comes with.

Contents

Safety & Warranty Warnings	1
Overview & What's Inside	3
Bed Base	4
Important Notes Before Assembly	5
Leg Positions & Height	6
Assembly	7
Wireless Remote Control	11
Wireless Remote Control Pairing	12
Warranty Information	13

Safety & Warranty Warnings

IMPORTANT: PLEASE READ ALL INFORMATION CAREFULLY BEFORE USING THIS PRODUCT. SAVE THESE INSTRUCTIONS.

WARRANTY WARNINGS

Do not open or tamper with control box, motors, or remote. The warranty will be void if the internal workings of these components are tampered with.

SAFETY WARNINGS

- Do not use bed outdoors.
- Using the bed with oxygen administering equipment, other than the nasal masked type, can create a fire hazard.
- If using nasal or masked type oxygen administering equipment, ensure all tubing is routed and secured properly to stop it becoming entangled or damaged during normal operation of the bed.
- Keep moving parts free of obstruction during bed operation (including sheets, clothing, tubing, wiring, and products using electric power cords).

SAFE OPERATION

- Use caution when having liquids in or around the bed to ensure no spilling occurs. In case of spillage, stand in a dry, clean area of the floor and unplug the bed immediately. Clean up spill and allow the area around bed to dry thoroughly before using the electric controls again.
- Do not eat or drink hot liquids while operating the bed.
- Do not allow children or individuals with disabilities to operate the bed without appropriate supervision. Seek medical advice before use.
- Do not allow any person or pet under the bed at any time.
- During bed operation, make sure body is positioned within the confines of the bed.
- Do not place extremities over the sides of the bed when operating bed functions.
- After assembly is complete and power is connected, operate the remote control to ensure it is functioning correctly.
- Distribute body weight evenly over bed surface. Do not place entire weight on head or foot sections of the bed, during reposition, entering, or exiting bed.
- It is highly recommended to use an electrical surge protection device in conjunction with the ErgoLift-Pro. The surge protection device should be properly grounded and plugged directly into a grounded wall outlet.

WEIGHT LIMITS

- This product is not rated to support weight in excess of: 340.2 kgs
- The weight limit is inclusive of the mattress and bedding. The bed will structurally support this weight, provided it is evenly distributed across the foundation.
- The bed is not designed to support or lift this amount in the head or foot sections alone. Exceeding this weight restriction could damage the bed and/or cause injury, and will void the warranty.

HOSPITAL USE DISCLAIMER

This ErgoLift-Pro Adjustable Bed is designed for residential use only. It is not approved for hospital use and does not comply with hospital standards.

ELEVATION MOTOR OPERATING LIMITS

When using the head/foot/lumbar elevation functions, the motors are not designed to operate continuously for more than 1 minute in an 8-minute time period. Attempting to exceed these times will shorten the life expectancy of the foundation and will void the warranty.

FCC COMPLIANCE

- Operates on 2.4 GHz frequency transmitter.
- This device complies with Part 15 of the FCC Rules. Operation is subject to the following two conditions:
 1. This device may not cause harmful interference.
 2. This device must accept any interference received, including undesired operation.
- To comply with FCC Radio Frequency (RF) exposure requirements, no change to the antenna or the device is permitted. Any change to the antenna or the device could result in the device exceeding the RF exposure requirement and void user's right to operate the device.

Overview & What's Inside

GET TO KNOW YOUR ADJUSTABLE BED

Before beginning assembly, please take a moment to familiarise yourself with the parts and location of components as explained here.

If any parts or components are missing, or are different than shown in the images, **do not attempt** to complete the assembly process. Please contact our Customer Service Dream Team at: support@ecosa.com.au

1 Foldable Bed Base x1

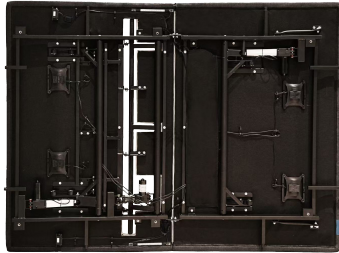

2 Wireless Remote x1
AAA Battery x2



3 3-Position Adjustable
Metal Legs x6



4 Mattress
Retainer Bar x1



5 Power Supply Box x1



6 Power Cord x1



Bed Base

- | | | |
|------------------------|----------------------------------|---------------------------|
| A Control Box | D Head Motor | G Massage Vibrator |
| B DC Power Line | E Enclosure Connectors x8 | H USB Port (A+C) |
| C Foot Motor | F Lumbar Motor | I Underbed Light |

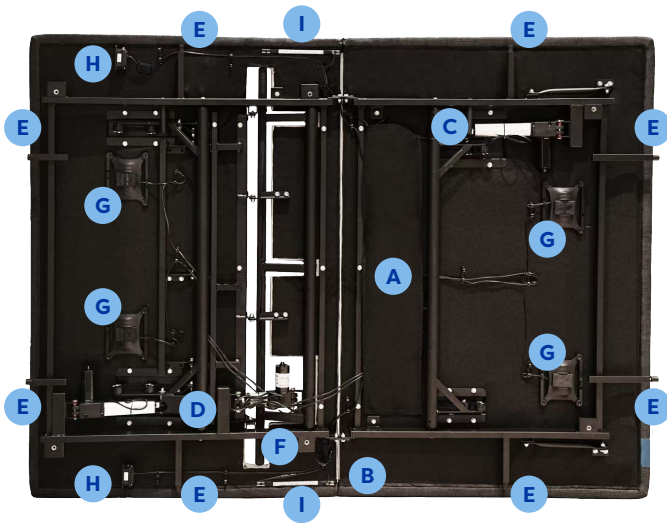

NOTES:



1. Two (2) to four (4) people are required to assemble this adjustable base.

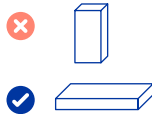

2. Open the carton in the flat position, bottom facing up, to avoid damage.

Important Notes Before Assembly

Your ErgoLift-Pro Adjustable Bed comes with adjustable legs (and extenders) so you can set it at the correct height – whether using it as a standalone base, on an existing base or within an existing frame/base (slats removed).

PLEASE READ THE BELOW BEFORE ADJUSTING AND INSTALLING THE LEGS

To ensure you set the height of your legs correctly, you first need to determine how you'll be using your Adjustable Bed.

- **For use with an Ecosa bed base or frame:**

See the table on the next page for the correct leg position to use.

Note: slats can be removed for all Ecosa bases/frames without storage.

- **For use within an existing bed base or frame (removing the slats):**

You will need to measure the height from the floor to the top of the slats. Then, follow the table on the next page for the correct leg position.

Note: After adjusting the ErgoLift-Pro height, it should be at the same level as the original slats were.

- **For use with an existing bed base or frame (on top of slats/base):**

Do not use legs. Place the Adjustable Bed directly onto the slats/base.

- **For use as a standalone base:**

Your height is up to you. Refer to the table for the range of positions available.

Leg Positions & Height

IF YOUR ERGOLIFT-PRO COMES WITH AN ECOSA BED BASE, ADJUST YOUR LEGS TO THE FOLLOWING POSITIONS.

Ecosa Product	Suggested Leg Position
Haven	Position 1. Fits with slats removed.
Rise	Position 1. Fits with slats removed.
Breeze (Luna, Cove, Nova, Drift, Alta)	Position 2. Fits with slats removed.
Zen	Position 3. Fits with slats removed.
Storage Beds	Do not use legs. Place directly onto the slats.



*Can't see your Ecosa bed base listed?
Scan the QR code for more details.*

IF YOU ARE USING THE ERGOLIFT-PRO WITH AN EXISTING BED BASE, REFER TO THE GUIDE BELOW FOR LEG POSITIONS.

Height from the floor to the top of slat holder	Suggested Leg Position
25.4 cm or less	Any position works. No extenders needed.
25.4 - 27.7 cm	Position 3, then adjust the extenders to reach the exact height.
Exactly 27.7 cm	Position 1 or 2. No extenders needed.
27.7 - 29.2 cm	Position 2, then adjust the extenders to reach the exact height.
Exactly 29.2 cm	Position 1. No extenders needed.
29.2 - 31.2 cm	Position 1, then adjust the extenders to reach the exact height.
More than 31.2 cm	Do not use legs. Place directly onto the slats.

Assembly

1

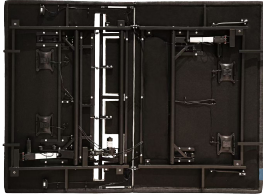

Remove Folded Bed Base **1** from the box and carefully unfold it. Set it mattress side down on the floor.

2



Open the accessories bag and ensure all accessories are included.

- Wireless Remote x1
- AAA Battery x2
- 3-Position Adjustable Metal Legs x6
- Mattress Retainer Bar x1
- Power Supply Box x1
- Power Cord x1

3

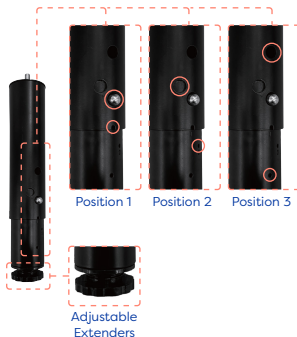

To change the height of the ErgoLift-Pro, the legs can be adjusted.

To adjust, press the silver button into the leg and slide up or down to your desired height, ensuring the button clicks into the new position. Repeat to the same position for each leg.

To get a more precise height, the extenders on the bottom of the legs can be twisted clockwise to give more height.

Refer to pages 5-6 for information on setting your legs to the correct height.

4



Ensure you have adjusted your legs to the correct height before installing the legs (and before turning the base mattress side up at step 7)

To install the Adjustable Metal Legs x6 **3**, thread the bolt of the leg into the frame and tighten by hand.

Note: This base is designed to be used with or without legs.

5



Install the Power Cord **6** into the Power Supply Box **5**.

6

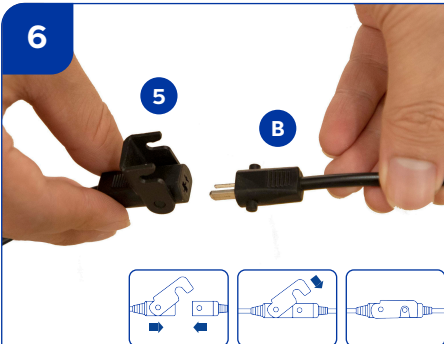

Connect the Power Supply Box **5** and DC Power Line **B** under the Bed Base and secure the connection by pressing down the lock.

7



With two (2) to four (4) people, lift the Bed Base by the frame and turn it over so the mattress side is facing up.

If desired, the ErgoLift-Pro Adjustable Bed can now be lifted into the center space of your existing bed base/frame (if slats can be removed).

 Take caution not to lift the bed with the fabric, or to use the legs as pivot points as this may cause damage.

 Avoid dragging the base across the floor.

8

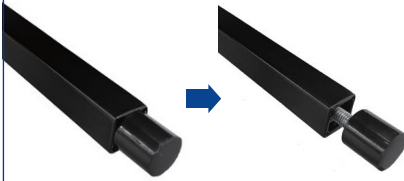

Note: This step is only required if you are using the ErgoLift-Pro inside an existing bed frame.

To secure the ErgoLift-Pro Adjustable Bed to your existing bed, screw the 8 side Enclosure Connectors **E** out until they are pressed snugly against the four side walls of your bed.

9



Ensure two (2) AAA Batteries (included) are installed correctly in the Wireless Remote **2**.

 Do not mix old and new batteries in the remote control.

 Do not mix alkaline, standard, or rechargeable batteries in the remote control.

10



To install the Mattress Retainer Bar **4**, insert both ends of the retainer bar in their respective slots in the base, until it slides fully into place.

11



Plug the Power Cord **6** into the wall outlet. You may want to familiarise yourself with the Remote Control functions found on pages 11-12.

Wireless Remote Control

 This remote requires two (2) AAA batteries (included) inserted in the back panel.



ADJUSTABLE BUTTONS



Head Up & Down:

Raise and lower the head section of the base.



Foot Up & Down:

Raise and lower the foot section of the base.



Lumbar Up & Down:

Raise and lower the lumbar section of the base.

ONE-TOUCH BUTTONS



Reading: Adjusts to the reading position, elevating the head with a slight incline at your feet.



Memory: Adjusts to the factory default memory position.

To set a new memory position, adjust the base to the desired position, press and hold 'Memory' for 5 seconds, until the backlight flashes.

To reset to original data, press 'Zero Gravity + Flat' simultaneously until the backlight flashes.



Zero Gravity: Adjusts to the zero-gravity position, elevating your feet with a slight incline at the head.



Anti Snore: Adjusts to the 'Anti Snore' position, giving you a slight incline at the head.



Flat: Lowers base to a flat position with no elevation.



Child Lock: To activate, press and hold the button until the backlight flashes. This disables all other functions. Deactivate by holding the button for 5 seconds, until the backlight flashes.

MESSAGE BUTTONS



Head/Foot Massage: Click to start.

Click sequentially to increase the intensity, as follows: 1 → 2 → 3 → 0 (Off).



Massage Mode: After massage is activated, click to switch between 4 different modes: Constant, Gentle Rhythm, Dynamic Rhythm, or Rapid Rhythm.



Massage Timer: After massage is activated, click to switch between massage durations as follows: 10min → 20min → 30min → 0 (Off).



Message ON/OFF: Click once to turn on both head and foot massage; click again to turn off. When ON, adjust settings using the 'Mode', 'Head' and 'Foot' buttons. Massage will turn ON at your last used setting.



Underbed Light: Press once to turn on the under-bed light. Press again to turn it off.

Wireless Remote Control Pairing

The original remote that comes in the box is already paired to your ErgoLift-Pro Adjustable Bed. No further action is required.

Troubleshooting

PROBLEM

SOLUTION

No features of the base will activate.

- Ensure the remote is paired correctly with the base (see below*).
- Ensure that all wired connections are correctly secured below the bed base.
- Unplug the power cord, wait 30 seconds and plug back in to reset electric components.
- The surge protection or the electrical outlet may be defective. Test the outlet by plugging in another working appliance.

*The remote control won't operate the bed functions.

In the event that the remote is not working, it may not be correctly paired with the base.

Troubleshoot by checking the following.

1. Ensure the two (2) AAA Batteries are functioning. Replace if necessary.
2. Unplug Power Cord from wall, wait a few seconds and then plug back in.
3. Within 10 seconds, press and hold the Pair button **1**. The backlight should flash, indicating it's in pairing mode.
Once the backlight stops flashing, and the indicator light on the bed base's control box turns green, pairing is complete.

If one or more functions of the bed has stopped working.

Check under the bed base to verify the wired connections are secure and there are no cords or bedding obstructing the movement of the base.

Warranty Information

FULL 5-YEAR WARRANTY

The Adjustable Bed is warranted against defects in materials or workmanship for a period of five (5) years from the date of purchase to the original purchaser. During such time, the manufacturer will repair or replace, at no cost to the original Purchaser, any warranted part(s) found to be defective by the manufacturer, in its sole discretion. This includes all pre-authorised labour and transportation costs incurred with the repair or replacement of any part found to be defective.

ADDITIONAL TERMS AND CONDITIONS

This warranty does not include reimbursement/ replacement for inconvenience, removal, part(s) installation, bed set up, loss of use, normal wear and tear, shipping or any other costs or expenses not expressly covered in this warranty. In addition, this warranty shall be void in the following circumstances:

- A. Damage resulting from misuse or abuse caused by the Purchaser or any third party.
- B. Damage caused by repairs or parts replacement by an unauthorized person.
- C. Damage caused if the Adjustable Bed has been mishandled, subjected to physical abuse or an improper power supply, or by failing to adhere to the User Manual and this warranty.
- D. Damaged mattresses, foundation cover(s), fabric(s), bedding cables, electrical cords or accessories supplied by dealers or any third party. Contact your dealer for warranty information on these items.
- E. Modification of the Adjustable Bed without prior written consent by the manufacturer.
- F. Costs for unauthorised service calls for the purpose of educating the consumer about the Adjustable Bed or locating proper functioning power outlets.
- G. Damage if the recommended weight restrictions are exceeded.
- H. Damage if used in any environment or a commercial setting which was not intended.

- I. This warranty requires notice to be given to Ecosa of any claim for repairs or replacement parts*.
- J. Damage to foam shroud by improper handling or misuse.
*Parts include the following:
 - a. Head/Foot/Lumbar Motor
 - b. Control Box
 - c. Remote Control
 - d. Power Cord, Power Supply, and DC power
 - e. 3-Position Adjustable Metal Legs
 - f. Enclosure Connectors
 - g. Mattress Retainer Bar
 - h. USB Charging
 - i. Underbed Lighting
 - j. Massage Vibrator

OTHER THAN AS EXPRESSLY SET OUT HEREIN, AND TO THE EXTENT PERMITTED BY APPLICABLE LAW, THIS WARRANTY IS EXCLUSIVE AND IN LIEU OF ALL OTHER ORAL OR WRITTEN WARRANTIES, REPRESENTATIONS, CONDITIONS OR PROMISES, WHETHER EXPRESS OR IMPLIED, AND WHETHER ARISING BY LAW, STATUTE, COURSE OF DEALING OR USAGE OF TRADE, INCLUDING, BUT NOT LIMITED TO, IMPLIED WARRANTIES AND CONDITIONS OF MERCHANTABILITY, QUALITY, DURABILITY AND/OR FITNESS FOR A PARTICULAR PURPOSE.

TO THE EXTENT PERMITTED BY APPLICABLE LAWS, ANY IMPLIED WARRANTIES (IF APPLICABLE) ARE LIMITED IN DURATION TO THE DURATION OF THIS WARRANTY. TO THE EXTENT PERMITTED BY APPLICABLE LAW, IN NO EVENT SHALL THE MANUFACTURER BE LIABLE FOR ANY SPECIAL, INCIDENTAL, PUNITIVE, EXEMPLARY, CONSEQUENTIAL, LIQUIDATED OR SIMILAR DAMAGES, WHETHER OR NOT FORESEEABLE.

This warranty is for the benefit of the original Purchaser only and is non-transferable. The benefits given to the original Purchaser (who is a consumer) under this warranty are in addition to other rights and remedies available to the consumer under the law.



ecosa .co.nz .com.hk
.com.au .com/ca